

Licensing Sub-Committee

Agenda

Wednesday 27 July 2022

6.30 pm

Online - Virtual Meeting

MEMBERSHIP

Administration:	Opposition:
Councillor Mercy Umeh (Chair) Councillor Paul Alexander (Vice-Chair)	Councillor Dominic Stanton

CONTACT OFFICER: Charles Francis
Committee Co-ordinator
Governance and Scrutiny
☎: 07776 672945
E-mail: Charles.Francis@lbhf.gov.uk

Public Notice

Members of the press and public are welcome to attend at the YouTube link below:

Speaking at Licensing meetings is restricted to those who have submitted a representation and registered to speak.

THIS MEETING WILL BE HELD REMOTELY It will be streamed via YouTube on:

<https://youtu.be/Du3IOBWpBR8>

Licensing Sub-Committee Agenda

27 July 2022

<u>Item</u>		<u>Pages</u>
1.	APOLOGIES FOR ABSENCE	
2.	DECLARATIONS OF INTEREST	
	<p>If a Councillor has a disclosable pecuniary interest in a particular item, whether or not it is entered in the Authority's register of interests, or any other significant interest which they consider should be declared in the public interest, they should declare the existence and, unless it is a sensitive interest as defined in the Member Code of Conduct, the nature of the interest at the commencement of the consideration of that item or as soon as it becomes apparent.</p> <p>At meetings where members of the public are allowed to be in attendance and speak, any Councillor with a disclosable pecuniary interest or other significant interest may also make representations, give evidence or answer questions about the matter. The Councillor must then withdraw immediately from the meeting before the matter is discussed and any vote taken.</p> <p>Where Members of the public are not allowed to be in attendance and speak, then the Councillor with a disclosable pecuniary interest should withdraw from the meeting whilst the matter is under consideration. Councillors who have declared other significant interests should also withdraw from the meeting if they consider their continued participation in the matter would not be reasonable in the circumstances and may give rise to a perception of a conflict of interest.</p> <p>Councillors are not obliged to withdraw from the meeting where a dispensation to that effect has been obtained from the Standards Committee.</p>	
3.	SELEKT CHICKEN, 349 NORTH END ROAD, LONDON SW6 1NN.	3 - 41

<u>Contents</u>	<u>Page</u>
1. THE APPLICATION	4
1.1. Application Requested	4
1.2. Applicants Operating Schedule	4
2. BACKGROUND	5
3. CONSULTATION	5
3.1 Relevant Representations	5
4. OTHER INFORMATION	6
4.1 Enforcement History	6
4.2 Temporary Event Notices (“TENS”)	6
5. POLICY CONSIDERATIONS	6-8
6. DETERMINATION	8-9

APPENDICES

Copy of application form and plans	10-15
Agreed conditions and relevant correspondence with the Police.....	16-18
Copy of withdrawal confirmation from the Licensing Authority	19
Copy of withdrawal confirmation from the Noise and Nuisance Authority.....	20
Map showing location of premises and neighbouring premises.....	21-23
Copy of objection from Cllr Ben Coleman	24
Copy of objection from Cllr Trey Campbell-Simon	25
Copy of objection from the Chair of the Fulham Broadway Ward Panel	26
Copy of objection from the Co-Chair of the Fulham Ward Panel	27
Copy of objection from the Barclay Road Neighbourhood Watch	28-29
Copy of objections from local residents	30-40
Responses from objectors to agreed conditions	41

1. THE APPLICATION

On 17 May 2022, Mr Farhad Khan Niaz (“the applicant”) submitted an application for a new premises licence to be granted in respect of the premises known as Selekt Chicken located at 349 North End Road London SW6 1NN.

1.1 Application Requested

The applicant has applied for a new premises licence for the provision of late night refreshment as outlined below:

The Provision of late night refreshment - Both Indoors and Outdoors

Monday to Sunday 23:00 – 03:00

Hours open to public:

Monday to Sunday 10:00 – 03:00

A copy of the application form and plans can be seen on pages 10-15 of this report.

1.2 Applicants Operating Schedule

The applicant has proposed a number of steps to promote the four licensing objectives if the application is granted. A copy of these steps can be seen on page 13 of this report.

On 20 June 2022, following correspondence received from the Police, the applicant agreed to amend their activity and opening hours as well as add extra conditions to their licence if granted. A copy of this amendment and relevant correspondence can be seen on pages 16-18 of this report. The agreed activity and opening hours are as follows:

The Provision of late night refreshment - Both Indoors and Outdoors

Sunday to Wednesday 23:00 – 00:00

Thursday to Saturday 23:00 – 01:00

Hours open to public:

Sunday to Wednesday 10:00 – 00:00

Thursday to Saturday 10:00 – 01:00

On 21 June 2022, the licensing section received one representation from the Licensing Authority objecting to the licence application. However, on 18 July 2022, based on the reduced hours and additional conditions agreed with the Police, the Licensing Authority confirmed that is able to withdraw its representation. A copy of relevant correspondence can be seen on page 19 of this report.

On 21 June 2022, the licensing section received one representation from the Noise and Nuisance Authority objecting to the licence application. However, on 15 July 2022, based on the reduced hours and additional conditions agreed with the Police, the Noise and Nuisance Authority confirmed that is able to withdraw its

representation. A copy of relevant correspondence can be seen on page 20 of this report.

2. BACKGROUND

The main access to the premise's unit will be located on North End Road. There is a mixture of both residential and commercial premises within the area (75m buffer zone). A map showing the location of the premises and neighbouring licensed premises can be seen on pages 21-23 of this report.

There are several options for transport away from the area including buses and taxis which run from in and around the North End Road area. West Kensington tube station is a 10-minute walk away and Fulham Broadway tube station is a 10-minute walk away.

3. CONSULTATION

A public notice was displayed at the premises for 28 days. The application was advertised in a local circular and all statutory consultees were notified as required by the Regulations. The Council has served written notice of hearing upon the applicant and all those parties that have made representations in respect of the application.

3.1. Relevant Representations

The licensing section received one representation from Cllr Ben Coleman objecting to the licence application. A copy of this representation can be seen on page 24 of this report.

The licensing section received one representation from Cllr Trey Campbell-Simon objecting to the licence application. A copy of this representation can be seen on page 25 of this report.

The licensing section received one representation from the Chair of the Fulham Broadway Ward Panel objecting to the licence application. A copy of this representation can be seen on page 26 of this report.

The licensing section received one representation from the Co-Chair of the Fulham Ward Panel objecting to the licence application. A copy of this representation can be seen on page 27 of this report.

The licensing section received one representation from the Barclay Road Neighbourhood Watch objecting to the licence application. A copy of this representation can be seen on pages 28-29 of this report.

The licensing section received 11 representations from local residents objecting to the licence application. A copy of these representations can be seen on pages 30-40 of this report.

On 14 July 2022 the licensing section received further comments from two objectors in response to the agreed hours and conditions between the applicant and the Police. A copy of these comments can be seen on page 41 of this report.

4. OTHER INFORMATION

4.1 Enforcement History

There have not been any warnings, simple cautions or prosecutions given in respect of the premises during the past three years.

4.2 Temporary Event Notices (“TENs”)

No TENs have been submitted in respect of this premises in the past twelve months.

5. POLICY CONSIDERATIONS

5.1 Section 5.1 page 12 of the Statement of Licensing Policy (“SLP”) states that where there is a relevant representation, the Licensing Authority will consider each particular case on its merits having regard in particular to the following matters:

- Whether the licensed activities are likely to have an adverse impact especially on local residents and, if there is potential to have an adverse impact, what, if any, appropriate measures will be put in place to prevent it;
- Whether there will be a substantial increase in the cumulative adverse impact from these or similar activities, on an adjacent residential area;
- Whether there is a suitable level of public transport accessibility to and from the premises at the appropriate times;
- Whether the activity will be likely to lead to a harmful and unmanageable increase in car parking demand in surrounding residential streets suffering high levels of parking stress or on roads forming part of the Strategic London Road Network or the London Bus Priority Network leading to a negative impact on the Licensing Objectives relating to the prevention of crime, disorder and nuisance; and
- Whether there have been any representations made by Responsible Authorities, or other relevant agency or representative.

5.2 Section 5.4 page 13 of the SPL states that the Licensing Authority advises applicants that it would be beneficial if a lawful planning use can be demonstrated for the activities proposed in all applications for premises licences.

5.3 Section 6.1 page 13 of the SLP states that in determining an application where there has been a relevant representation the Licensing Authority will, where appropriate, take into account the cumulative (collective) effect of the number, type and density of licensed premises already existing in the area. A saturation of licensed premises can attract customers to an area to such a degree that it has an adverse impact on the surrounding area beyond the control of individual licence holders.

5.4 Section 6.2 page 13 of the SPL states that in accordance with paragraph 13.30 of the Secretary of State’s current Guidance, where the cumulative effect of many licensed premises within an area gives rise to problems of public disorder and nuisance in the surrounding area the Licensing Authority may consider it inappropriate for any further licensed premises to be established in the area or

extension to licensed hours of existing premises to be approved. In such circumstances, an application for a licence for activities which would undermine the promotion of any of the four Licensing Objectives would be refused.

5.5 Section 8.1 page 15 of the SLP states that the Licensing Authority will require applicants to detail in their operating schedule the steps proposed to ensure the deterrence and prevention of crime and disorder on, and in the vicinity of, the premises, having regard to their location, character, condition, the nature and extent of the proposed use and the persons likely to use the premises.

5.6 Section 9.1 page 17 of the SLP states that the Licensing Authority will require the applicant to detail in their operating plan the steps proposed to ensure the physical safety of people using the relevant premises or place.

5.7 Section 10.3 page 19 of the SLP states that the Licensing Authority will particularly consider the following matters where they are material to the individual application:

- The proximity of residential accommodation;
- The type of use proposed, including the likely numbers of customers, proposed hours of operation and the frequency of activity;
- The steps taken or proposed to be taken by the applicant to prevent noise and vibration escaping from the premises, including music, noise from ventilation equipment, and human voices. Such measures may include the installation of soundproofing, air conditioning, acoustic lobbies and sound limitation devices;
- The steps taken or proposed to be taken by the applicant to prevent disturbance by customers arriving at or leaving the premises. This will usually be of greater importance late at night and/or in the early hours of the morning. However, nuisance can arise at any time of the day or night so the Licensing Authority will consider representations from Responsible Authorities and/or Interested Parties relating to potential nuisance from any activity at all times dependent on the merits of the application/steps taken or proposed to prevent nuisance.
- The steps taken or proposed to be taken by the applicant to prevent queuing (either by pedestrian or vehicular traffic). If some queuing is inevitable then queues should be diverted away from neighbouring premises or be otherwise managed to prevent disturbance or obstruction;
- The steps taken or proposed to be taken by the applicant to ensure staff leave the premises quietly;
- The arrangements made or proposed for parking by patrons, and the effect of parking by patrons on local residents;
- The provision for public transport in the locality (including taxis and private hire vehicles) for patrons;
- The level of likely disturbance from associated vehicular and pedestrian movement to and from the premises;
- The delivery and collection areas and delivery/collection times;
- The siting of external lighting, including security lighting that is installed inappropriately;
- The arrangements for refuse disposal, storage and the prevention/tidying of litter (including fly posters and illegal placards);
- The generation of odour, e.g. from the preparation of food;
- Any other relevant activity likely to give rise to nuisance;

5.8 Section 15.11 pages 30 and 31 of the SLP states that the following provides a non-exhaustive list of risks associated with the public nuisance objective that applicants may want to consider when preparing their Operating Schedule:

- **Deliveries/collections** – noise from deliveries to and/or collections (e.g. refuse) from the premises are another common source of complaint. Consider the times of such deliveries/collections and make sure you specify to any contractors that deliveries/collections should not be made at antisocial times. As a guide, the Noise and Nuisance Service recommend that deliveries/collections should only be made between the hours of 7:30am and 9:00pm, depending on the proximity of residential and/or other noise-sensitive properties.
- **Late night refreshment** - applicants in respect of late night takeaways should demonstrate that they have assessed the risk of persons congregating in large numbers in the vicinity of their premises. Where appropriate, applicants should demonstrate suitable measures to address this problem.
- **Light pollution** – this is an increasingly common source of complaint, particularly from illuminated signs and external security lighting. Where provided, illuminated signs should not cause glare to neighbouring properties, ideally being turned off at night, and external lighting should be angled and/or diffused to also prevent nuisance.
- **External Areas** – External areas such as gardens can be the source of noise disturbance to surrounding premises. Consider limiting the use of the garden to a reasonable time and number of people.
- **Odour** – odour from cooking is a common source of complaint, particularly from restaurants and fast-food takeaways. The Council's Noise and Nuisance Service may therefore require evidence that the kitchen ventilation and/or extract systems are regularly maintained and serviced to ensure that it is operating efficiently and with minimal nuisance to neighbours arising from odour and also noise. This includes the siting of BBQs.
- **Queue management** - establishing appropriate procedures to avoid the need for customers to queue before entering the premises or, where queuing cannot be avoided, to manage queues so as to minimise the potential for crime and disorder or public nuisance by customers who are queuing.
- **Waste** – consider how and where waste will be stored/disposed of at the end of trading hours, particularly if trading until late at night. This is important because the disposal of glass and/or cans to outside bin areas can be very noisy and give rise to complaints, so it may be necessary to store such items and other non-degradable refuse inside the premises until the next trading day. Consideration should also be given to the time of deliveries to minimize disruption to local residents.
- **Litter** – for example, litter patrols for late night take-away premises

6. DETERMINATION

6.1 In determining this application, the Committee must have regard to the representations and take such of the following steps as it considers necessary for the promotion of the licensing objectives. The steps are:

- (a) Grant the application in full

- (b) Grant the application in part – modifying the proposed hours, activities or conditions.
- (c) Reject the application.

It is the Council's duty under the Licensing Act 2003 ("The Act") to determine applications with a view to promoting the four licensing objectives; Prevention of Crime and Disorder, Public Safety, Prevention of Public Nuisance and the Protection of Children from Harm.

In reaching a decision the Council shall consider the details of any relevant representations received; the applicant's Operating Schedule; the Council's adopted Statement of Licensing Policy and the guidance issued by the Secretary of State under section 182 of the Act.

If the Committee is minded to grant the application, conditions may be attached to the licence to alleviate the concerns raised through any representation(s).

Application for a premises licence to be granted under the Licensing Act 2003

Case number 2022/00813/LAPR

Payment transaction reference 256-9299

Amount paid £190

Date submitted 17/05/2022

Are you the applicant or Applicant their agent?

PREMISES DETAILS

Premises address

349 North End Road, London SW6 1NN

If the premises could not be found please enter the address here, or if the premises has no address give a detailed description (including the Ordnance Survey references)

Trading name (if any) SELEKT CHICKEN

Telephone number at the premises (if any) [REDACTED]

Are the premises in the course of construction?

No

Non-domestic rateable value if the premises 17000

Will the premises be exclusively or primarily used for the supply of alcohol for consumption on the premises?

No

APPLICANT DETAILS

I am applying as an individual or individuals

Title Mr

Name FARHAD KHAN NIAZ

Address 349
SELEKT Chicken North End Road
LONDON
SW6 1NN

Date of birth [REDACTED]

Nationality [REDACTED]

Where applicable, your 9 digit sharecode [REDACTED]

Daytime/ business telephone number [REDACTED]

Evening/ home telephone number [REDACTED]

Mobile phone number [REDACTED]

Email address [REDACTED]

I confirm that: I am carrying on or proposing to carry on a business which involves the use of the premises for licensable activities

Alternative details for correspondence

Contact name (if different from premises user)

Business name

Correspondence address

Daytime/ business telephone number

Evening/ home telephone number

Mobile phone number

Email address

OPERATING SCHEDULE

When do you want the premises licence to start?

20/06/2022

If you want the licence to be valid for only a limited period, when do you want it to end?

If 5,000 or more people are expected to attend the premises at any one time, please state the number expected to attend

Please give a general description of the premises.

GROUND FLOOR AND BASEMENT SHOP, CURRENTLY TRADING AS FAST FOOD TAKEAWAY RESTAURANT

What licensable activities do you intend to carry on from the premises?

late night refreshment

HOURS OPEN TO THE PUBLIC

Standard days

Mondays

Start 10:00

Finish ~~23:00~~ 03:00

Tuesdays

Start 10:00

Finish ~~23:00~~ 03:00

Wednesdays

Start 10:00

Finish ~~23:00~~ 03:00

Thursdays

Start 10:00

Finish ~~23:00~~ 03:00

Fridays

Start 10:00

Finish ~~23:00~~ 03:00

Saturdays

Start 10:00
Finish ~~23:00~~ 03:00

Sundays

Start 11:00
Finish ~~23:00~~ 03:00

Please state any seasonal variations

NONE

Non standard timings. Where you intend to use the premises at different times to those listed above, please list

LATE NIGHT REFRESHMENT

Please give further details here

I WANT A LICENCE FOR PROVISION OF HOT FOOD BETWEEN THE HOURS OF 23:00 TO 03:00

Will the provision of late night refreshment take place indoors, outdoors or both?

~~Indoors~~ Both Indoors and Outdoors

Standard days

Mondays

Start 23:00
Finish ~~23:00~~ 03:00

Tuesdays

Start 23:00
Finish ~~23:00~~ 03:00

Wednesdays

Start 23:00
Finish ~~23:00~~ 03:00

Thursdays

Start 23:00
Finish ~~23:00~~ 03:00

Fridays

Start 23:00
Finish ~~23:00~~ 03:00

Saturdays

Start 23:00
Finish ~~23:00~~ 03:00

Sundays

Start 23:00
Finish ~~23:00~~ 03:00

Please state any seasonal variations

NONE

Non standard timings. Where you intend to use the premises for late night refreshment at different times to those listed above, please list.

START TIME 23:00

END TIME 03:00

MONDAY TO SUNDAY

Please highlight any adult entertainment or services, activities, other entertainment or matters ancillary to the use of the premises that may give rise to concern in respect of children

NONE

Describe the steps you intend to take to promote the licensing objectives

a) General- all four licensing objectives (b,c,d and e)

WILL SERVE HOT FOOD INDOOR, KEEP IT CLEAN AND NO NOISE.

b) The prevention of crime and disorder

HAVE CCTV INSTALLED AND OUR CUSTOMERS ARE WELL BEHAVED. NO ALCOHOL SERVED.

c) Public safety

INDOOR SERVICE. SO NO DANGER TO PUBLIC AT ALL

d) The prevention of public nuisance

INDOOR SERVICE. TAKEAWAY IS ENCOURAGED

e) The protection of children from harm

PREMISES ALWAYS STAFFED AND EVERY CARE TAKEN TO KEEP CHILDREN SAFE

DECLARATIONS

I have enclosed a plan of the premises

Yes

I have included documents demonstrating my entitlement to work in the United Kingdom or my share code issued by the Home Office online right to work checking service (Applicable to all individual applicants, including those in a partnership which is not a limited liability partnership, but not companies or limited liability partnerships).

I understand I must now advertise my application

Yes

It is an offence, under section 158 of the Licensing Act 2003, to make a false statement in or in connection with this application. Those who make a false statement may be liable on summary conviction to a fine of any amount.

It is an offence under section 24b of the Immigration Act 1971 for a person to work when they know, or have reasonable cause to believe, that they are disqualified from doing so by reason of their immigration status. Those who employ an adult without leave or who is subject to conditions as to employment will be liable to a civil penalty under section 15 of the Immigration, Asylum And Nationality Act 2006 and pursuant to section 21 of the same act, will be committing an offence where they do so in the knowledge, or with reasonable cause to believe, that the employee is disqualified.

Applicable to individual applicants only, including those in a partnership which is not a limited liability partnership] I understand I am not entitled to be issued with a licence if I do not have the entitlement to live and work in the UK (or if I am subject to a condition preventing me from doing work relating to the carrying on of a licensable activity) and that my licence will become invalid if I cease to be entitled to live and work in the UK.

I have the consent of any individuals or third parties listed in this form to provide their personal details and I am authorised to submit this application on behalf of all applicants.

I have read the privacy policy and agree for my details to be used by the council to contact me about this application and any changes to this service that may affect me.

I agree to the above Yes I agree to the above declaration

Full name FARHAD KHAN NIAZ

Capacity

Date 17/05/2022

349 NORTHEAST ROAD

SCALE 1:100 JUNE 1999
DRAWING NO. 2693/12A

NOTE:
RED LINES AROUND THE FLOOR PLAN INDICATE BOUNDARIES
A, B, C ARE FIRE EXTINGUISHERS IN THE KITCHEN AND L IS FIRE EXTINGUISHER IN BASEMENT.
D IS A CUSTOMER SERVICE COUNTER.
E, F, G, H, I, J, K ARE CUSTOMER SEATINGS AND TABLES FOR EAT IN
R IS MAIN ENTRANCE AND EXIT TO THE SHOP
S IS A FIRE EXIT AT THE BACK IN THE BASEMENT

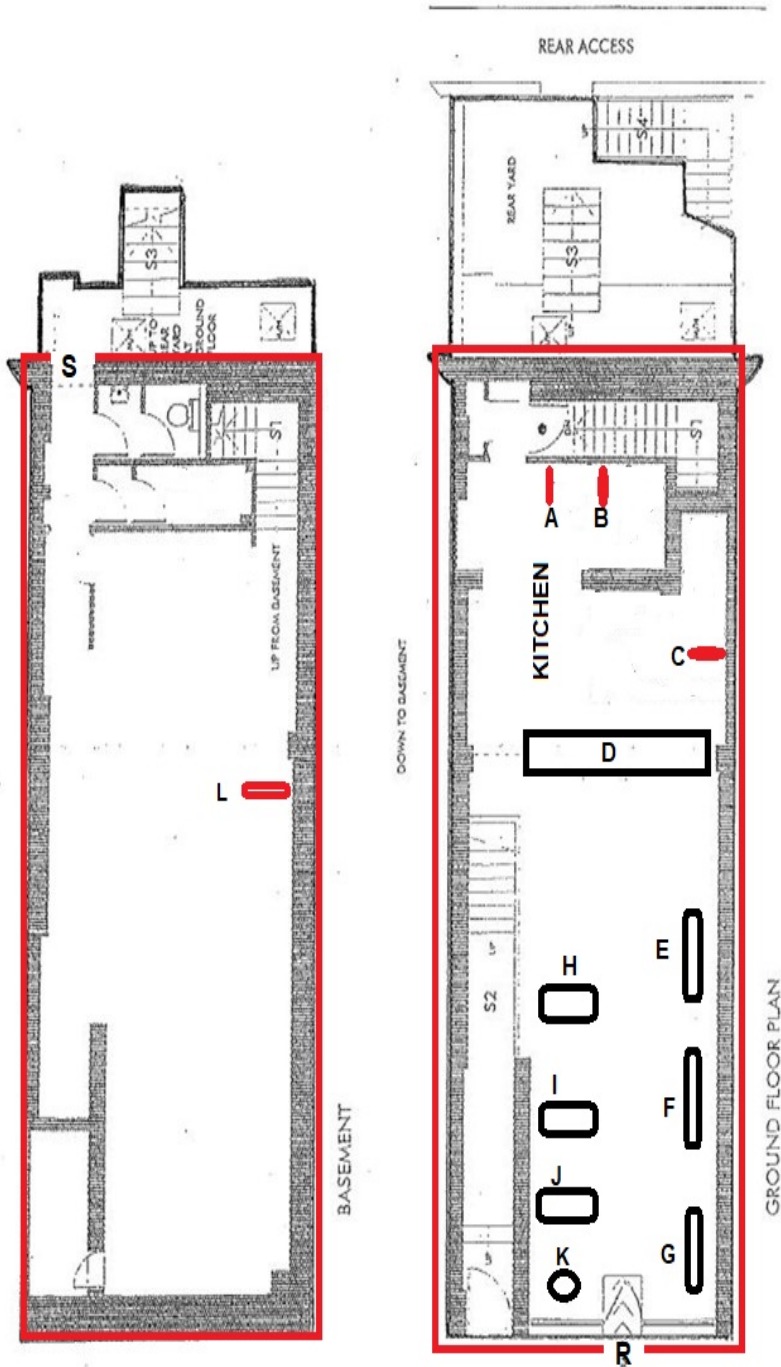

From:
Sent: 20 June 2022 15:57
To: Licensing HF: H&F
Cc:
Subject: 2022/00813/LAPR:- Selekt Chicken 349 North End Road London SW6 1NN

Good Afternoon Licensing,

Please refer to the attached conditions agreed (highlighted in red below) between the Police and the Applicant for the above application.

Kind regards,

Kris.

Kris Cardwell
Police Constable 3286AW
Licensing Officer - Hammersmith and Fulham (Central West BCU)
Metropolitan Police Service

From: Cardwell Kris J - AW-CU
Sent: 20 June 2022 15:50
To: Farhad Niaz
Cc: Sondh Nicole K - AW-CU
Subject: RE: 2022/00813/LAPR:- Selekt Chicken 349 North End Road London SW6 1NN

Hi Farhad,

Many thanks for your email and to agreeing the conditions proposed by the Police.

If myself or Nicole can assist you further then please let me know,

Kind regards,

Kris.

Kris Cardwell
Police Constable 3286AW
Licensing Officer - Hammersmith and Fulham (Central West BCU)
Metropolitan Police Service

From: Farhad Niaz
Sent: 20 June 2022 15:15
To: Cardwell Kris J - AW-CU
Cc: Sondh Nicole K - AW-CU
Subject: Re: 2022/00813/LAPR:- Selekt Chicken 349 North End Road London SW6 1NN

Hi Kris

It was a pleasure speaking to you earlier today. I agree with your proposal stated in this email. And I assure my local police force of my full cooperation in making sure no public disorder or problems for the local residents take place.

Regards
FARHAD khan NIAZ

On Monday, June 20, 2022, 1:51 pm, Kristen Cardwell wrote:

Good Afternoon Farhad,

It was good to speak to you just now and discuss your application and the concerns that the Police have.

As I stated, the Police would not object to the following timings:-

The Provision of late night refreshment - Both Indoors and Outdoors
Sundays-Wednesdays inclusive between the hours of 23:00 to 00:00
Thursdays-Saturdays inclusive between the hours of 23:00-01:00

Hours Open to the Public:
Sundays to Wednesdays between the hours of 10:00 to 00:00
Thursdays to Saturdays between the hours of 10:00-01:00.

As I mentioned, several conditions are required to be placed on the premises licence to ensure that the premises operates responsibly and promotes the licensing objectives. I recommend the following conditions also be added to the premises licence:-

1.High Definition CCTV shall be installed, operated and maintained, at all times that the premises are open for licensable activities and;

- shall be checked every two weeks to ensure that the system is working properly and that the date and time are correct. A record of these checks, showing the date and name of the person checking, shall be kept and made available to Police or authorised Council officers on request**
- one camera will show a close-up of the entrance to the premises, to capture a clear, full length image of anyone entering.**
- shall cover any internal or external area of the premises where licensable activities take place.**

- recordings shall be in real time and stored for a minimum period of 31 days with date and time stamping.
- footage shall be provided free of charge to Police or authorised council officer within 24 hours of a request.
- a staff member from the premises that is conversant with the operation of the CCTV system shall be on the premises at all times. This staff member will be able to show police or authorised officers of the Licensing Authority recent data footage with the minimum of delay when requested. This data or footage reproduction shall be almost instantaneous

2.Appropriate signage shall be displayed in prominent positions, informing customers they are being recorded on CCTV

3. Signs shall be prominently displayed in the outside area reminding patrons that there are residents living nearby and instructing them to respect neighbours and to conduct their behaviour accordingly.

4.Notices shall be prominently displayed at all exits used by delivery drivers requesting them to respect the needs of local residents and leave the area quietly

5.After 23:00, drivers shall wait inside the premises between deliveries/for deliveries

6.Delivery drivers/riders will be given clear, written instructions to use their vehicles in a responsible manner so as to not cause nuisance to any residents or generally outside the licensed premises; not to leave engines running when the vehicle is parked; and not to obstruct the highway. The licence holder will positively encourage delivery drivers/riders to use quieter vehicles that are less likely to cause a nuisance such as bicycles

As the last day of objection to this application is tomorrow, please can you let me know if you agree to the proposed timings and conditions as a matter of urgency/

Kind regards,
Kris.

Kris Cardwell
Police Constable 3286AW
Licensing Officer - Hammersmith and Fulham (Central West BCU)
Metropolitan Police Service

From: Overton Adrian: H&F
Sent: 18 July 2022 11:11
To: Dimitriou Maria: H&F
Cc: Layug Karen: H&F
Subject: RE: Agreed hours and conditions with the Police - Premises: Selekt Chicken 349 North End Road London SW6 1NN

Dear Ms Dimitriou,

Thank you for this. I can confirm that based on these reduced hours and additional conditions the Licensing Authority is able to withdraw its representation.

Yours sincerely

Adrian Overton
Licensing Policy & Enforcement Manager
Licensing
The Environment Department
Hammersmith & Fulham Council

From: Overton Adrian: H&F
Sent: 21 June 2022 18:03
To: Dimitriou Maria: H&F
Cc: Perez-Trillo Cristina: H&F; Layug Karen: H&F
Subject: Selekt Chicken, 349 North End Road, SW6 1NN - 2022/00813/LAPR

Dear Ms Dimitriou,

I would like to make a representation to this application on behalf of the Licensing Authority in relation to the following licensing objectives :

- the prevention of crime and disorder.
- the prevention of public nuisance.

We believe that the hours requested for late night refreshment will add to existing problems with ASB in the surrounding area.

A full representation will be forwarded shortly.

Yours sincerely

Adrian Overton
Licensing Policy & Enforcement Manager
Licensing
The Environment Department
Hammersmith & Fulham Council

From: Rawlinson James: H&F
Sent: 15 July 2022 19:51
To: Dimitriou Maria: H&F
Cc: Cardwell Kris J - AW-CU; Nicole Sondh
Subject: RE: Agreed hours and conditions with the Police - Premises: Selekt Chicken 349 North End Road London SW6 1NN

Hi Maria

On the basis of these revised hours and conditions, noise and nuisance are happy for our representation to be removed.

Thanks

James Rawlinson
Noise and Nuisance Officer
Resident services
Hammersmith & Fulham Council

From: Rawlinson James: H&F
Sent: 21 June 2022 16:42
To: Asante William: H&F
Cc: Licensing HF: H&F; Boniface Simon: H&F
Subject: RE: Licensing Act 2003 - Reference: 2022/00813/LAPR

Hi William and Licensing

Having reviewed this application with regards to the context of the times requested, the location, and with regards to the current opening times of other premises of a similar nature along North End Road, noise and nuisance recommend refusal on the basis of upholding the Licensing Act Objective of Prevention of Public Nuisance. With careful consideration of the aforementioned local context, is it considered by this department that allowing this premises to open until 3 am would both increase noise and late night antisocial behaviour in a mixed commercial and residential area.

Regards

James Rawlinson
Noise and Nuisance Officer
Resident services
Hammersmith & Fulham Council

London Borough of Hammersmith & Fulham

- LBHF Borough Boundary
- Licensing Points
- Mastermap Lines
- Property Gazetteer
 - Within Borough
 - Out of Borough
- Street Gazetteer
- Street Labels

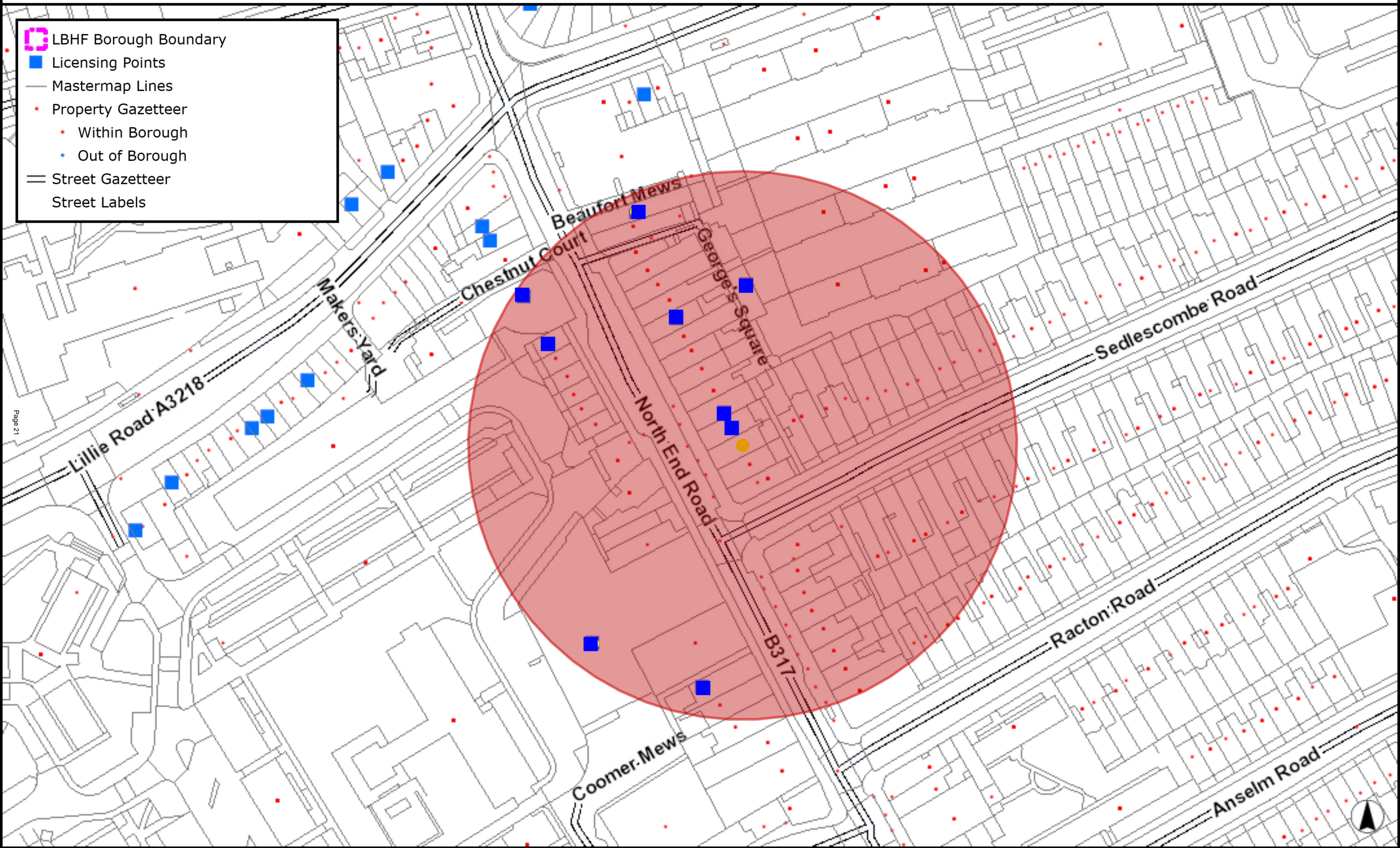

Page 21



Reference Number	Trading As	Premises Address	Activities	Monday to Sunday	Monday	Tuesday	Wednesday	Thursday	Friday	Saturday	Sunday
2020/00992/LAPR	East African Cuisine	335 North End Road London SW6 1NN	Sale of Alcohol On and Off the Premises	12:00:00 - 21:30:00							
2018/01301/LAPR	Chicken Cottage	264 North End Road London SW6 1NJ	Provision of Late Night Refreshment	23:00:00 - 01:00:00							
2021/00768/LAPR	Boutique da Carne Ltd	323 North End Road London SW6 1NN	Sale of Alcohol Off the Premises		10:00:00 - 20:00:00	10:00:00 - 20:00:00	10:00:00 - 20:00:00	10:00:00 - 20:00:00	10:00:00 - 20:00:00	09:00:00 - 20:00:00	09:00:00 - 20:00:00
2018/01308/LAPR	Ghion Cafe And Restaurant	1 Clem Attlee Parade North End Road London SW6 7RS	Provision of Late Night Refreshment	23:00:00 - 23:30:00							
			Sale of Alcohol On the Premises	12:00:00 - 23:00:00							
2021/00038/LAPR	Elenes Kitchen (Unit 7, 345-347)	345 North End Road London SW6 1NN	Sale of Alcohol On the Premises	11:00:00 - 23:00:00							
2020/00686/LAPR	A Sora Lella	347 North End Road London SW6 1NN	Provision of Late Night Refreshment					23:00:00 - 00:30:00	23:00:00 - 00:30:00	23:00:00 - 00:30:00	
			Sale of Alcohol On and Off the Premises		12:00:00 - 22:00:00	12:00:00 - 22:00:00	12:00:00 - 22:00:00	12:00:00 - 22:00:00	12:00:00 - 22:00:00	12:00:00 - 22:00:00	12:00:00 - 21:00:00
2022/00823/LAPR	Co-operative	254 - 258 North End Road London SW6 1NJ	Sale of Alcohol Off the Premises		08:00:00 - 23:00:00	08:00:00 - 23:00:00	08:00:00 - 23:00:00	08:00:00 - 23:00:00	08:00:00 - 23:00:00	08:00:00 - 23:00:00	10:00:00 - 22:30:00
2021/00583/LAPR	The Goose		Exhibition of a Film		10:00:00 - 00:00:00	10:00:00 - 00:00:00	10:00:00 - 00:00:00	10:00:00 - 00:00:00	10:00:00 - 01:00:00	10:00:00 - 01:00:00	10:00:00 - 00:00:00
			Indoor Sporting Event		10:00:00 - 00:00:00	10:00:00 - 00:00:00	10:00:00 - 00:00:00	10:00:00 - 00:00:00	10:00:00 - 01:00:00	10:00:00 - 01:00:00	10:00:00 - 00:00:00
		248 North End Road London SW6 1NL	Playing of Recorded Music								
			Provision of Late Night Refreshment		23:00:00 - 00:00:00	23:00:00 - 00:00:00	23:00:00 - 00:00:00	23:00:00 - 00:00:00	23:00:00 - 01:00:00	23:00:00 - 01:00:00	23:00:00 - 00:00:00

Sale of Alcohol On and
Off the Premises

10:00:00 - 10:00:00 - 10:00:00 - 10:00:00 - 10:00:00 - 10:00:00 - 10:00:00 -
00:00:00 00:00:00 00:00:00 00:00:00 01:00:00 01:00:00 00:00:00

2021/01316/LAPR

Shop and Donate CIC

Estate Office Peabody
Estate Lillie Road
London SW6 1UH

Sale of Alcohol Off the
Premises

10:00:00 - 10:00:00 - 10:00:00 - 10:00:00 - 10:00:00 -
16:30:00 16:30:00 16:30:00 16:30:00 16:30:00

From: Cllr Coleman Ben: H&F

Sent: 09 June 2022 13:20

To

Cc:

Subject: Re: Licensing Act 2003 - Reference: 2022/00813/LAPR

William

Thank you for inviting comments on the above application. Following representations from residents, I am writing to oppose an extension of opening hours for this business.

I am not aware of any food business in North End Road that currently stays open beyond 11pm. Permitting this business to trade after 11pm will mean an increase in delivery bicycles and motorcycles to and from the premises. Councillors already receive numerous complaints about delivery vehicles in North End Road - not just vehicle noise but the noise (as well as pavement obstacles) caused by drivers waiting to pick up deliveries. Extending the hours of this business will disturb residents further and may disrupt their sleep.

Regards

Ben Coleman

Deputy Leader of the London Borough of Hammersmith & Fulham

Councillor for Lillie ward

From: Cllr Campbell-Simon Trey: H&F

Sent: 09 June 2022 13:36

To:

Cc:

Subject: Re: Licensing Act 2003 - Reference: 2022/00813/LAPR

Hello William,

I hope you are well.

I (along with residents) agree with all the points Cllr Coleman has raised with regards to this application. Therefore, I oppose any extension of opening hours also.

Kind Regards,

Trey Campbell-Simon

Lead Member for Youth Advancement & Councillor for Walham Green Ward

Comments summary

Dear Sir/Madam,
Licensing Application comments have been made. A summary of the comments is provided below.
Comments were submitted at 20/06/2022 9:51 PM from Ms Sarah Chambers.

Application Summary

Address: 349 North End Road London SW6 1NN

Proposal: Licensing Act - Premises Licence

Case Officer: Maria Dimitriou

[Click for further information](#)

Customer Details

Name: Ms Sarah Chambers

Email:

Address: Gironde Road London

Comments Details

Commenter Type: Residents Group

Stance: Customer objects to the Licensing Application

Reasons for comment:

Comments: 20/06/2022 9:51 PM I am writing in my capacity as Chair of the Fulham Broadway Ward Panel, made up of local residents and groups who work with the police and council regarding crime and anti-social behaviour.
This business is currently selling hot food beyond 11pm without a license to do so. Approval to sell hot food beyond 11pm and especially after midnight will result in significantly more anti-social behaviour on the North End Road. This will impact residents of the North End Road and surrounding streets, and contravenes the licensing objective of preventing crime and disorder.
The noise of customers and delivery drivers entering and exiting the premises plus the parking on the North End Road and nearby will disturb the sleep of residents and their families well into the early hours of the morning.
The council have recently made many improvements along the North End Road including hard landscaping and installing trees and plants. This benefits the area during the day. The council's plans have not considered the possibility of the night time economy developing through to 3am and beyond.
I would be grateful if the committee could please limit the sale of hot food to 11pm. If the committee is minded to grant a licence, no hot food should be served beyond midnight.
Thank you.

Kind regards

Comments summary

Dear Sir/Madam,
Licensing Application comments have been made. A summary of the comments is provided below.
Comments were submitted at 21/06/2022 10:20 AM from Miss Annabel Cottrell.

Application Summary

Address: 349 North End Road London SW6 1NN

Proposal: Licensing Act - Premises Licence

Case Officer: Maria Dimitriou

[Click for further information](#)

Customer Details

Name: Miss Annabel Cottrell

Email:

Address: Shottendane Road London

Comments Details

Commenter Type: Residents Group

Stance: Customer objects to the Licensing Application

Reasons for comment:

Comments: 21/06/2022 10:20 AM I represent the 180 households in Fulham as Chair of a residents' association and I am also the Co-Chair of a Fulham Ward Panel.

It has come to our attention that this company has been flouting the law by providing refreshments without a licence after 11pm. Therefore the Licencing Committee should be circumspect about rubber stamping the application.

As the premises is in close proximity to residential properties it is not consistent with the Licencing Objectives to allow them to operate until 3am both inside and outside, as it would cause a public nuisance with increased noise and altercations.

If the Committee is minded to grant the application we ask that it should only be till midnight, inside only and that any vechile used for home deliveries should be electric/pedal cycles, to avoid the increasing problems of noise and disturbance caused by motorbikes in the wider area.

Kind regards

From: Charlotte Dexter

Sent: 21 June 2022 23:00

To: Dimitriou Maria: H&F

Cc: Overton Adrian: H&F; Licensing HF: H&F

Subject: 2022/00813/LAPR: Selekt Chicken: 349 North End Road London SW6 1NN 21 June deadline

2022/00813/LAPR: Selekt Chicken: 349 North End Road London SW6 1NN 21 June deadline

I was unable to submit this online, so, I write on behalf of residents in our Council-registered Barclay Road Neighbourhood Watch (NHW), SW6 1EJ and SW6 1EH, this also includes our very active WhatsApp NHW ALERTS group of 81 households and individuals who are very concerned about this application, for two reasons; one for keeping North End Road open beyond midnight when more crime and disorder is unfortunately inevitable in this big city on a main A road with a lot of outlets, and two for the inevitable motorbike noise of deliveries and zooming even on Fulham Road late at night when there is less traffic and no enforcement of speed limits. It makes it difficult to sleep in this big city and it leads to altercations, between delivery drivers and motorists/bicyclist and pedestrians.

Operating illegally:

Residents are VERY concerned that 349 North End Road is operating and has been operating for some time until midnight, without a license to sell indoors and outdoors' Late Night Refreshment'.

We respectfully ask the Licensing Sub-Committee to consider, why reward a shop/Premises that has been operating illegally?

Would it not be better for them to take the Licensing Authority and Met Police advice to shut at 23:00 and prove that they have done this for some time, before granting them hours for what is, in simple terms, illegal, and bad behaviour? I am attaching/sending to the Licensing officer a screen grab of a Deliveroo App order; one can see that orders can be taken until 23:45 and that the order will be delivered within 25 minutes. This in itself raises a few questions about whether they really close at midnight.

North End Road regeneration LBHF scheme:

We give high praise to Leader Cowan and LBHF for the vast improvements underway now in North End road (grants of £1.2 million received and further money spent by the Council), for better access for market stall holders, traffic calming methods, parking pushed off North End Road, loading bays created on side roads for deliveries in North End Road etc.

What we also notice is that the plan for North End Road improvements is all about the daytime economy. The night time economy is not mentioned at all in the close to £2 million scheme, and for good reasons. There are no plans for North End Road to turn into a night time economy.

McDonalds closes at midnight due to planning restrictions regarding amenity of the many residences above the shops of North End Road (especially from Lillie Road down to Fulham Road) and residences on side roads up and down this same part of what we call here 'lower' North End Road.

We are very concerned about the licensing objective, The Prevention of Crime and Disorder. Beyond this chicken shop operating illegally ie without a proper license but open till at least midnight...we bring to the Committee's attention the following

Crime on the rise again:

The recent statistics included in the Draft Licensing Policy Consultation (closes 24 June on haveyoursay website) show that crime is again on the rise in North End Road, and the neighboring Fulham Broadway core area/zone after a hiatus due to COVID closures/restrictions.

More noise and nuisance

ie disorder, public safety (Licensing Objectives) at risk in and around the Premises applying for this License.

A licence until 3am could add to the ongoing problems in North End Road at late night hours. 349 North End Road is in close proximity to residential properties, with several directly above as well as across the road and so would harm the amenities of these properties as a result of noise and disturbance, particularly late at night, generated by customers and delivery drivers entering and leaving both the Premises itself and neighboring residential side streets where customers are likely to park their vehicles and delivery drivers tend to congregate.

In conclusion,

Post COVID, crime in North End Road is rising, unfortunately, not only during the day but also at night; more delivery drivers causing altercations with vehicles and bicycles, cycle altercations, problems at McDonalds (open till midnight) including robberies witnessed by families with children are becoming too common at McDonalds and at the various food outlets on North End Road, again. Residents on the NextDoor app report these unfortunate incidences, specifically in North End Road Premises, all too regularly.

The Council is making great strides in improving North End Road during daytime hours through traffic calming measures such as 'parklets', wider pedestrian pavements and improved facilities for market traders; the emphasis of these North End Road improvements is solely on daytime activity. The nighttime economy is not at all addressed in the Council's plans for North End Road, most likely because no one envisions North End Road becoming an all-night destination. Although Planning is a separate matter, all planning decisions on North End road include specific mention of amenity, noise, nuisance, proximity to residential properties and likelihood of harming the amenities of those properties as a result of noise and disturbance, particularly late at night.

A "Premises" in the new Delivery Economy is being extended from what was a counter where food was served and paid for directly/at the same time, to a collection counter where food is dispatched and the Premises elongates itself to the front door of the person who ordered the food. Until the handover, the sale is not complete. We fully appreciate that the Licensing Committee and its Sub-Committee is now grappling with the reality of this very real situation; the Premises now extends itself through residential roads, causing all kinds of problems, especially late at night.

Were the Lic Sub-Committee minded to grant a new License at this time, which we hope it is not, we ask for it to be for no later than 12 midnight. A general stop at 23:00 and sometimes, perhaps at midnight for North End Road will lead to less crime and disorder and a better handle on Public Safety overall, 2 of the four most important licensing objectives in this context of this specific application. The Police do not have the resources to patrol this area; thus, the lack of any oversight, bar when things become so bad that someone rings 999, calls for clear and concise hours that help to self-regulate things in North End Road, at least this portion of it south of Lillie Road down to Fulham Road/roundabout.

attachment: one screen shot of Deliveroo order platform for 349 North End Road, showing 23:45 as last order and 25 minutes to deliver.

Thank you for your consideration of our concerns.

Charlotte Dexter
 Neighbourhood Watch Barclay Road, registered with the LBHF Council/NHW platform
 Barclay Road Residents NHW WhatsApp ALERTS group (81 households and individuals)
 Barclay Road SW6 1EJ

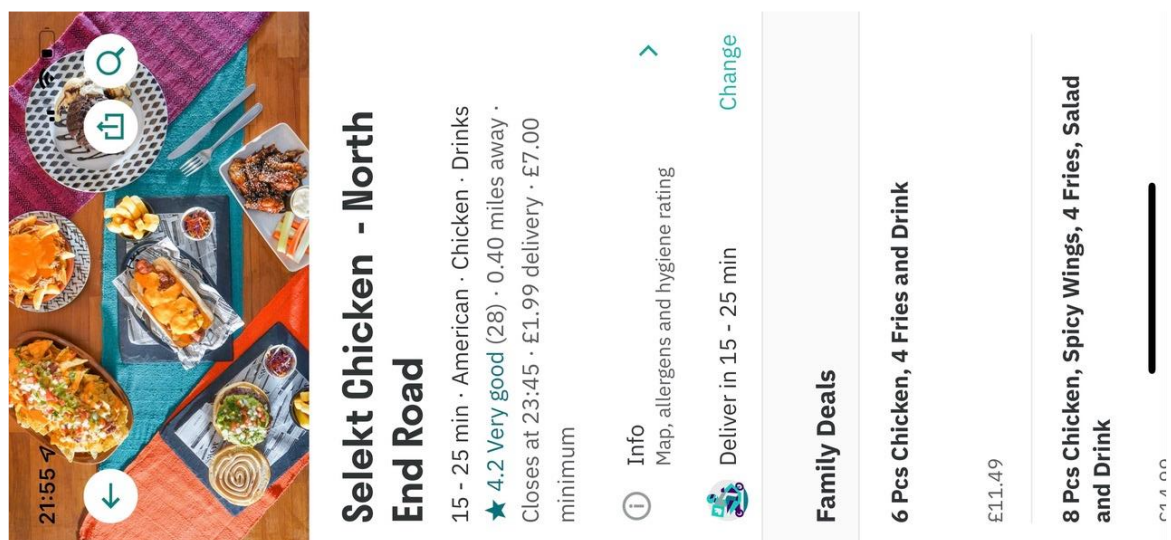

Comments summary

Dear Sir/Madam,
Licensing Application comments have been made. A summary of the comments is provided below.
Comments were submitted at 09/06/2022 1:32 PM from Mr Mark Richardson.

Application Summary

Address: 349 North End Road London SW6 1NN

Proposal: Licensing Act - Premises Licence

Case Officer: Maria Dimitriou

[Click for further information](#)

Customer Details

Name: Mr Mark Richardson

Email:

Address: Fulham Palace Road London

Comments Details

Commenter Type: Residents Group

Stance: Customer objects to the Licensing Application

Reasons for comment:

Comments: 09/06/2022 1:32 PM In the application they want to open until 3.00 in the morning and at present are open until 11.00 pm - nearby pubs including the Prince and the Cock Tavern shut at 11.00 pm. Their Google page says that they are open until midnight - if so they are already in breach of their present licence which may mean that they will add extra hours on to any extended licence. KFC and other nearby competitors close at 11.00pm or earlier. So presumably they want to be the only fast food business open in quite a wide area and will also do a lot of work with food delivery companies which will mean delivery scooters and bicycles coming and going until 3.00 pm or later at a time that the rest of the road is quite quiet. The local residents who live above the retail premises in North End Road presumably hear the market traders arriving when they start at 5.00 - 6.00 am and it seems to me that it will unfairly penalize them by allowing what will inevitably be noisy coming and going of delivery drivers until past 3.00 am so that they will only get a couple of hours of uninterrupted sleep. I really think that they should not be given a licence to trade later than 11.00 and that there should be some investigation as to whether they are in breach of their present licence

Kind regards

Comments summary

Dear Sir/Madam,
Licensing Application comments have been made. A summary of the comments is provided below.
Comments were submitted at 21/06/2022 6:42 AM from Lorraine Moran.

Application Summary

Address: 349 North End Road London SW6 1NN

Proposal: Licensing Act - Premises Licence

Case Officer: Maria Dimitriou

[Click for further information](#)

Customer Details

Name: Lorraine Moran

Email:

Address: Shorrolds Road London

Comments Details

Commenter Type: Residents Group

Stance: Customer objects to the Licensing Application

Reasons for comment:

Comments: 21/06/2022 6:42 AM I think the crime rate would go up if this was allowed

Kind regards

Comments summary

Dear Sir/Madam,
Licensing Application comments have been made. A summary of the comments is provided below.
Comments were submitted at 21/06/2022 8:16 AM from Miss Ruth Finnis.

Application Summary

Address: 349 North End Road London SW6 1NN

Proposal: Licensing Act - Premises Licence

Case Officer: Maria Dimitriou

[Click for further information](#)

Customer Details

Name: Miss Ruth Finnis

Email:

Address: Beaufort Court London

Comments Details

Commenter Type: Neighbour

Stance: Customer objects to the Licensing Application

Reasons for comment:

Comments: 21/06/2022 8:16 AM There is already far too much anti-social behaviour and noise in the area and this will only perpetuate the situation. This outlet is already making the situation worse by selling food beyond their existing licensed hours - we have to suffer the noisy road, the football fans, the drunken idiots coming from The Prince and Udderbelly - ENOUGH!

Kind regards

Comments summary

Dear Sir/Madam,
Licensing Application comments have been made. A summary of the comments is provided below.
Comments were submitted at 21/06/2022 9:58 AM from Ms Maria Papapaschali.

Application Summary

Address: 349 North End Road London SW6 1NN

Proposal: Licensing Act - Premises Licence

Case Officer: Maria Dimitriou

[Click for further information](#)

Customer Details

Name: Ms Maria Papapaschali

Email:

Address: Lillie Road London

Comments Details

Committer
Type: Neighbour

Stance: Customer objects to the Licensing Application

Reasons for
comment:

Comments: 21/06/2022 9:58 AM The area is already intimidating enough in the evening and this will definitely not help. The licensing objective to prevent crime and antisocial behaviour will be further breached. Please make our neighbourhood safer.

Kind regards

Comments summary

Dear Sir/Madam,
Licensing Application comments have been made. A summary of the comments is provided below.
Comments were submitted at 21/06/2022 9:59 AM from Mr R L Lau.

Application Summary

Address: 349 North End Road London SW6 1NN

Proposal: Licensing Act - Premises Licence

Case Officer: Maria Dimitriou

[Click for further information](#)

Customer Details

Name: Mr R L Lau

Email:

Address: Lillie Road London

Comments Details

Commenter Type: Residents Group

Stance: Customer objects to the Licensing Application

Reasons for comment:

Comments: 21/06/2022 9:59 AM I am very concerned that crime and anti-behaviour will increase on the NER if people are hanging around until this time. It also creates a precedent and other businesses may apply for the same very late license.
I have experienced racial abuse in a number of occasions and I fear late night license premises are problematic near residential housing estate.

Kind regards

Comments summary

Dear Sir/Madam,
Licensing Application comments have been made. A summary of the comments is provided below.
Comments were submitted at 21/06/2022 10:32 AM from Mr Ben Brabyn.

Application Summary

Address: 349 North End Road London SW6 1NN

Proposal: Licensing Act - Premises Licence

Case Officer: Maria Dimitriou

[Click for further information](#)

Customer Details

Name: Mr Ben Brabyn

Email:

Address: Tournay Road London

Comments Details

Commenter Type: Neighbour

Stance: Customer objects to the Licensing Application

Reasons for comment:

Comments: 21/06/2022 10:32 AM I am concerned that further extending the licensing hours will encourage more antisocial behaviour in the early hours of the morning, undermining the licensing objective of reducing crime and disorder. It would also set a precedent for other establishments on the North End Road.

Kind regards

Comments summary

Dear Sir/Madam,
Licensing Application comments have been made. A summary of the comments is provided below.
Comments were submitted at 21/06/2022 12:31 PM from Mr Billy Seago.

Application Summary

Address: 349 North End Road London SW6 1NN

Proposal: Licensing Act - Premises Licence

Case Officer: Maria Dimitriou

[Click for further information](#)

Customer Details

Name: Mr Billy Seago

Email:

Address: Lillie Road London

Comments Details

Commenter Type: Neighbour

Stance: Customer objects to the Licensing Application

Reasons for
comment:

Comments: 21/06/2022 12:31 PM I object to this licence application on the grounds of a potential increase in anti-social behaviour, crime, litter and noise.
Selekt Chicken are already in breach of their existing licence as they are selling food beyond 11pm. Granting a licence would reward this breach of licencing conditions.
I am concerned that late night opening will result in an increase in anti-social behaviour and crime as people congregate inside and outside the premises.
Granting a late night licence would create a precedent and future activity is likely to run counter to the licencing objective to reduce crime and disorder.

Kind regards

Comments summary

Dear Sir/Madam,
Licensing Application comments have been made. A summary of the comments is provided below.
Comments were submitted at 21/06/2022 9:03 PM from Miss Toni Mentz.

Application Summary

Address: 349 North End Road London SW6 1NN

Proposal: Licensing Act - Premises Licence

Case Officer: Maria Dimitriou

[Click for further information](#)

Customer Details

Name: Miss Toni Mentz

Email:

Address: Lillie Rd London

Comments Details

Commenter Type: Neighbour

Stance: Customer objects to the Licensing Application

Reasons for comment:

Comments: 21/06/2022 9:03 PM We have a lot of noise and anti social behaviour already without a 3am license. When are we supposed to sleep with 24 hour noise. There is no need for a 3am license when you have delivery companies serving food day and night. We need to feel safe and already the area is full of crime. This will contribute.

Kind regards

From: John Skoulding
Sent: 21 June 2022 10:58
To: Licensing HF: H&F
Cc: John Skoulding
Subject: 2022/00813/LAPR

Hi

I have tried continually this morning to submit my comments online but multiple errors keep occurring even though all the data has been completed. So here is my email:

Application Reference: 2022/00813/LAPR
Address: 349 North End Road London SW6 1NN
Licence Category: Licensing Act - Premises Licence
Application Type: New

Your Title: Mr
Your First Name: John
Your Surname: Skoulding
Your Address: Tournay Road, London SW6 7UF
Your Tel. No
Your Email Address:

Commenter Type: Neighbour
Stance: Object

As a local resident of over 20 years I am and have become increasingly concerned about the balance between reasonable commercial interests and the rights of residents in these matters. The North End Road (NER) is surrounded by roads that are a fully residential and indeed the NER is itself only semi-commercial. Late night disturbances are becoming and have increasingly been an every encroaching issue especially during the sensitive hours when families including our young children are trying and need to sleep.

Licensing Objective Prevention of Crime and Disorder: From what I have witnessed, Selekt Chicken 349 NER is already trading illegally, without any license at all to serve 'Late Night refreshment' after 23:00. Their hours have been until midnight, as shown on Google maps until 3 days ago, and Deliveroo is still offering orders from this shop until 23:45. This is illegal and illustrates a complete disregard for playing by the existing rules. What conditions (see my comments in the next paragraph) are there to ensure that LBHF will enforce against this and why should we trust an operator who already ignores the law?

Why reward a Premise/site that has not been upholding the law by granting them a licence for 3am? It makes total sense for the Premises to show that they can work within the law for at least a year or more and then apply for a licence for one hour after 23:00?

Post COVID, crime in NER is rising, unfortunately, not only during the day but also at night; more delivery drivers causing altercations with vehicles and bicycles, cycle altercations, problems at McDonalds (open till midnight) including robberies witnessed by families with children are becoming too common, again. Residents on the NextDoor app report these unfortunate incidences, specifically in NER Premises, regularly. We constantly struggle against bicycle and noisy moped dispatch riders racing at over the speed limit on our street, riding on the pavements, congregating late at night on our residential road, blocking pavements, dropping litter, urinating etc.

Licensing Objective The Prevention of Public Nuisance (you must use this exact phrase)

A licence until 3am could add to the ongoing problems in North End Road at late night hours. 349 North End Road is in very close proximity to residential properties, with several directly above as well as across the road and so would harm the amenities of these properties as a result of noise and disturbance, particularly late at night, generated by customers and delivery drivers entering and leaving both the Premises itself and neighbouring residential side streets where customers are likely to park their vehicles

and delivery drivers tend to congregate. What good to the local community does the sale of alcohol post-midnight possibly do?

We have also seen instances where younger people are being sold alcohol and have had regular problems at night with them running and screaming down our road, hitting our cars, smashing glass bottles of alcohol, littering outside our houses etc.

The Council with the full support of residents is making huge and welcome improvements to the NER during daytime hours through traffic calming measures such as 'parklets', wider pedestrian pavements and improved facilities for market traders.

All of this is at a very significant cost no doubt partly funded by the Council Tax bills we pay. The aim of these NER improvements is solely on daytime activity. The night-time economy is not at all addressed in the Council's plans for NER, most likely because no one at the Council appears to be considering the NER, from Fulham Road up to Lillie Road, becoming a 'late night' or even all-night destination. For us the positive steps made to boost business during the daytime must be balanced with respect for residents' concerns and their living space at night. It cannot and should not be all one-way. The deal was always put to us as one to attract more people to the NER and the market during the day six days a week but respecting the needs and rights of families (who after all will shop and spend more time and money using the NER facilities if they are implemented responsibly).

If the Licencing Sub-Committee is minded to grant a License at this time, we ask for it to be for no later than 12 midnight.

John Skoulding

From: Rowena Skoulding
Sent: 21 June 2022 15:09
To: Licensing HF: H&F
Subject: Ref: 2022/00813/LAPR: Selekt Chicken: 349 North End Road London SW6 1NN for 3am

I have had the opportunity to read, and I agree with the Representation of John Skoulding. Please accept this as my Representation.

If there should be a hearing regarding this application, I hereby give my 5 minutes to John Skoulding or his representative.

Yours faithfully,
Rowena Skoulding
Tournay Road SW6

From: Alastair Walton
Sent: 21 June 2022 15:36
To: Licensing HF: H&F
Cc: John Skoulding
Subject: Ref:2022/00813/LAPR: Selekt Chicken: 349 North End Road London SW6 1NN

Dear Sir/Madam

Ref:2022/00813/LAPR: Selekt Chicken: 349 North End Road London SW6 1NN for 3am

I have had the opportunity to read, and I agree with the Representation of John Skoulding. Please accept this as my Representation.

Possible hearing:

If there should be a hearing regarding this application, I hereby give my 5 minutes to John Skoulding or his representative. Pls note this important point.

Cheers Alastair WALTON
Tournay Road London SW6 7UF

From: Sarah Chambers
Sent: 14 July 2022 11:02
To: Dimitriou Maria: H&F
Subject: Re: Agreed hours and conditions with the Police - Premises: Selekt Chicken 349 North End Road London SW6 1NN

Dear Maria,

Many thanks for this update.

The issue of late night licensing and the example of Selekt Chicken was raised at last night's Fulham Broadway Ward Panel.

Residents are very concerned about the extension of licenses beyond midnight. They believe it will lead to anti-social behaviour and crime in this neighbourhood in addition to causing noise and disturbance for residents who are trying to sleep nearby.

Residents are likely to accept an extension to midnight but no later.

Kind regards
Sarah
Chair - Fulham Broadway Ward Panel

From: Ben Brabyn
Sent: 14 July 2022 18:37
To: Dimitriou Maria: H&F
Subject: Re: Agreed hours and conditions with the Police - Premises: Selekt Chicken 349 North End Road London SW6 1NN

Dear Maria

Thank you for your email. I believe that we should avoid establishing a precedent for opening hours after midnight, so the current proposal is not satisfactory.

Yours sincerely

Ben Brabyn